

Endorsement on Back.
 Franklin County
 Lewis Williams, & T. David.
 42^{acs} & 56^{pts} of 1000^{acs}
 Ref'd, &c. 25th April, 1857.
 (in, N.I.)
 Accepted 25 April, 1857.

*Courses, & distances down
 Licking Creek.*

79	N	79	E	48.0
80	S	79	E	48.0
81	S	79	E	48.0
82	S	79	E	48.0
83	S	79	E	48.0
84	S	79	E	48.0
85	S	79	E	48.0
86	S	79	E	48.0
87	S	79	E	48.0
88	S	79	E	48.0
89	S	79	E	48.0
90	S	79	E	48.0
91	S	79	E	48.0
92	S	79	E	48.0
93	S	79	E	48.0
94	S	79	E	48.0
95	S	79	E	48.0
96	S	79	E	48.0
97	S	79	E	48.0
98	S	79	E	48.0
99	S	79	E	48.0
100	S	79	E	48.0
				182.7 perches.

*Courses, & Distances around the whole
 tract Beginning at a white oak on the
 Line of the Lands formerly of John
 Wray, thirty one, and four tenths perches
 from the Original Corner.*

1	S	30	W	22.2	Stone
2	N	48	W	11.1	Stone
3	S	26	W	51.7	Post
4	N	13	W	42.7	"
5	N	16	W	22.3	"
6	S	70	W	12.3	"
7	N	18	W	3.9	"
8	N	69	E	3.4	"
9	N	6	E	9.5	"
10	N	80	E	4.5	"
11	N	35	W	32.2	"
12	S	20	W	3	"
13	S	37	W	6.6	"
14	S	14	W	22.9	"
15	N	82	E	7	"
16	S	13	W	13	Walnut
17	N	41	W	11	Post
18	S	50	W	5.5	"
19	N	69	W	18	"
20	N	65	W	35.3	"
21	N	80	W	8.1	"
22	N	17	E	36	"
23	N	48	W	59	"
24	N	47	E	3	To middle of the Creek.
25	N	79	E	8	"
26	S	40	E	8	"
27	S	20	E	8	"
28	S	54	E	4	"
29	N	64	E	6	"
30	S	67	E	4	"
31	S	5	E	16.5	"
32	S	54	E	6	"
33	N	88	E	4	"
34	S	18	E	8.7	"
35	S	87	E	13	"
36	S	44	E	20	"
37	S	29	E	8	"
38	S	66	E	8.7	"
39	N	77	E	10	"
40	S	85	E	11	"
41	N	37	E	3	"
42	N	15	E	7	"
43	N	2	W	10.6	"
44	N	60	E	15	Post
45	S	52	E	9	W.O. Beg.

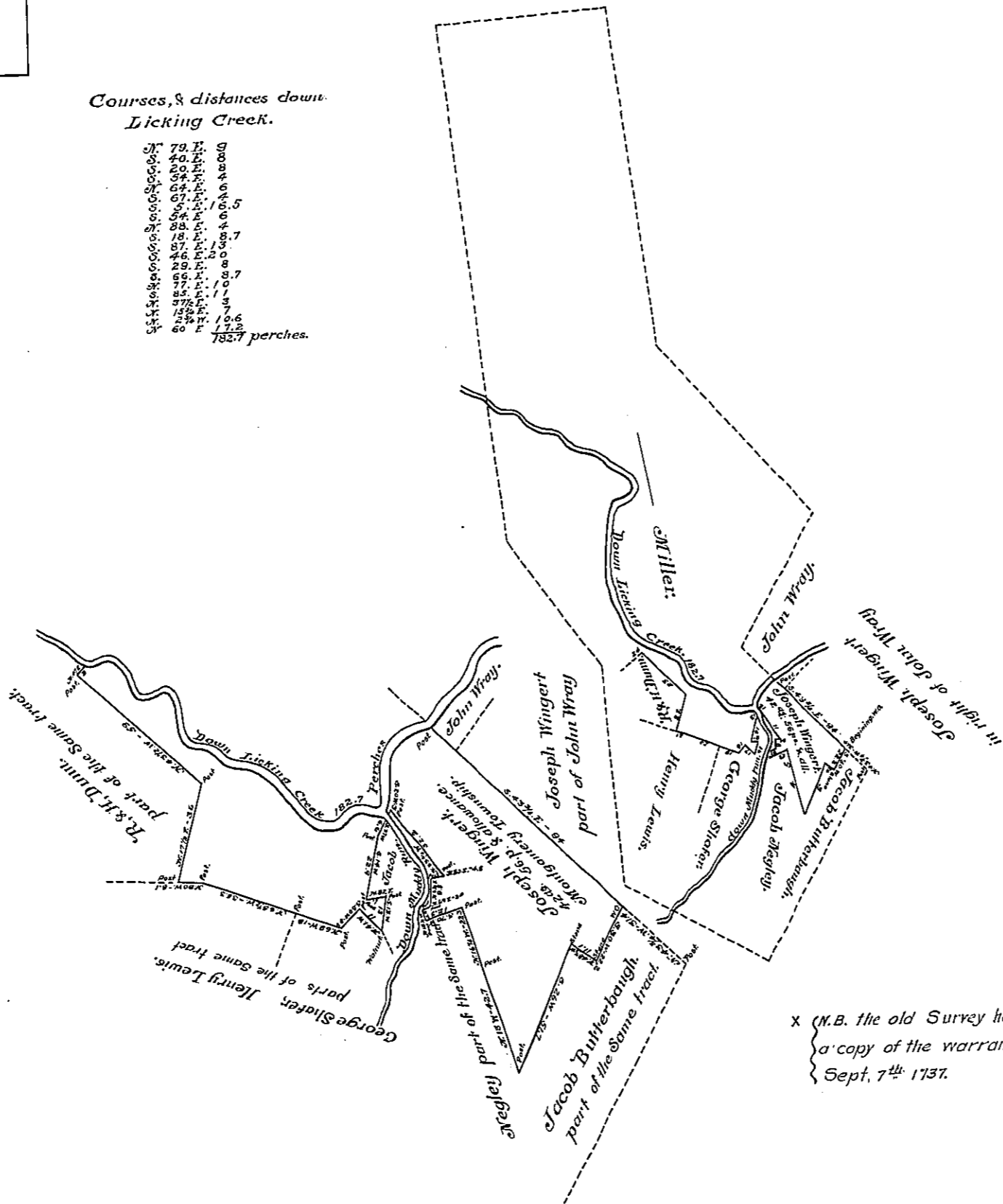

Draught of a tract of Land Situate in Montgomery Township Franklin County Pa Containing forty two acres and fifty six perches, & allowance of six per cent for Roads, &c. part of 1000 acres formerly Surveyed in pursuance of a warrant granted to Lewis Williams, & Thomas David dated (July 21st 1738 or Sept, 7th 1737. x) Resurveyed and laid off the above part for Joseph Wingert March 21st, & 22, 1854.

To J. Porter Brawley, Esq.
 S.G.

Emmanuel Kuhn, C.S.

In Testimony, That the above is a copy of the original remaining on file in the Department of Internal Affairs of Pennsylvania made conformably to an Act of Assembly approved the 16th day of February, 1833. I have hereunto set my Hand and caused the Seal of the said Department to be affixed at Harrisburg the first day of August 1910.

Henry Houck,
 Secretary of Internal Affairs.